

LumiLightBox™ #15

Standard Double-Sided

CUSTOMIZABLE

// Any size up to 4' x 8'

BRIGHT & EVEN ILLUMINATION

// 3D V-Cutting technology
// Superior consistent light quality
// Super thin & super bright

EASY INSTALLATION

// Plug & play installation

LONG LIFESPAN

// Patented heat sink technology to maximize LED lifespan (70,000 hours)

ENERGY EFFICIENT

// Low power consumption (70% less than fluorescent)
// Energy saving and maintenance free

WARRANTY

// Advanced 3-year warranty



Frame Color

Silver



SLIM PROFILE

LumiLightBox™ #15 (Standard Double-Sided) provides the aesthetic and application benefit of a snap frame that is 1 5/16" (33.4mm) deep with a 1 9/16" (40mm) front profile width and has the even and consistent illumination benefit of the LumiSheet™ LED light panel. The Light Box Double Sided snap frame design provides a rapid and easy changing of the graphic image on both sides of the frame. Ideally used to increase your product display while maximizing your

Integrated High Quality LEDs

LumiLightBox™ utilizes the LumiSheet™ technology which relies upon high quality 12V, constant voltage LEDs positioned internally, around the perimeter of the light box.



3D V-Groove Light Guide Plate (LGP)

LumiLightBox™ incorporates the LumiSheet™ technology as the light source for this unique product offering. A crystal clear acrylic with a bonded diffusion layer combined with a patented 3D V-groove etched grid pattern provides bright, even illumination.

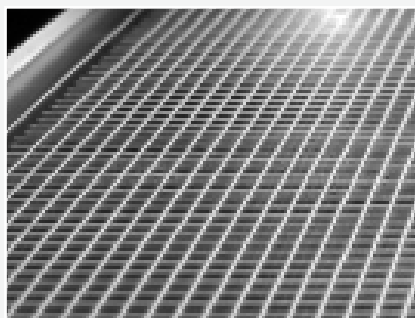

Integrated Thermal Management

All LEDs create heat which is detrimental to their life span. LumiLightBox™ implements LumiSheet™ and its patented technology which integrates the heat sink into the LGP to efficiently remove heat which results in longer life.

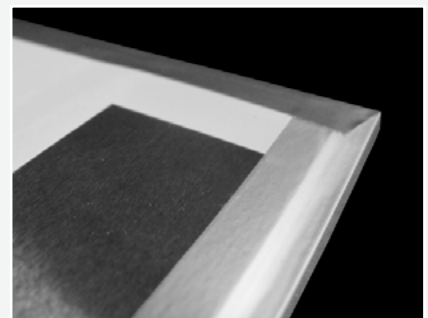

SPECIFICATIONS

ELECTRICAL							
Input Voltage	12 Volt DC - Constant Voltage						
Power Consumption	3.5 Watts/ft (3000K, 3500K, 5300K, 6300K)	4.5 Watts/ft (4100K)	4.5 Watts/ft (Tunable White LEDs)	5.0 Watts/ft (RGB LEDs)			
Wire Size	20 AWG 2 wire (Standard LEDs)	20 AWG 3 wire (Tunable White LEDs)		22 AWG 4 wire (RGB LEDs)			
Wiring	Each panel must have direct connection to power supply. Do not wire panels in series.						
*Connector	2.1/5.5mm barrel plug [Center pin +] (Standard/HO LEDs)	3-pin molex (Tunable White LEDs)	No connector (RGB LEDs)	Custom connection types available			
Certification	UL / cUL (E334549)						
PHYSICAL							
Color Temperature	Warm White ~3000K	Soft White 3500K	Neutral White ~4100K	Pure/Cool White ~5300K	Ultra White 6300K	Tunable White 3000K - 6500K	Color Adjustable RGB
Mounting Examples	Wall mounted with screws, hanging, or pendant with hanging wires						
Operating Temperature	-30 °C (-22 °F) ~ +40 °C (+104 °F)						
Environment	Dry location only (Standard)						
Thickness	8mm						
Minimum Size	8 1/2"W x 11"L x 5/16"D (216mm x 279mm x 8mm)						
Maximum Size	48" W x 96"L x 5/16"D (1219mm x 2438mm x 8mm)						
Weight	1.95 lbs/sq. ft. (8mm LGP)			9.54 kg/sq. M (8mm LGP)			
FRAME SERIES #		LLB12-13					
Frame Width	1 9/16" (40mm)						
Frame Thickness	1 11/16" (43mm)						
Frame Material & Color	Anodized Aluminum Snap Frame			Color: Silver			
POWER & CONTROLS							
Please contact Evo-Lite for optimal power & control solutions to fit your requirements							

* Standard 5' (1500mm), Optional 10' (3000mm)



PROFILE DIMENSIONS

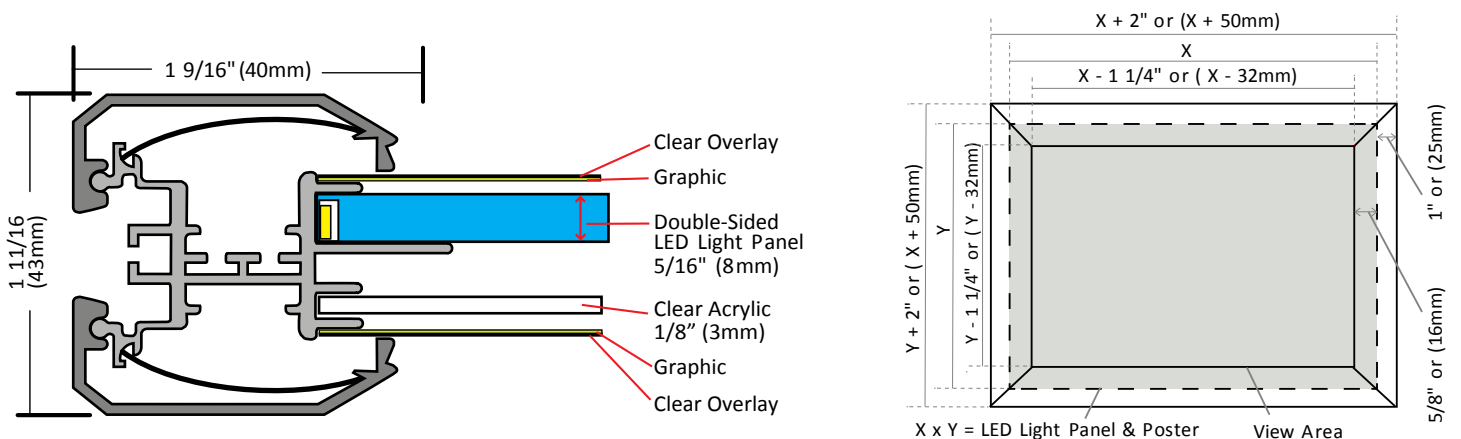

MOUNTING OPTIONS *(All Mounting Hardware Sold Separately)*

1 J-HOOK

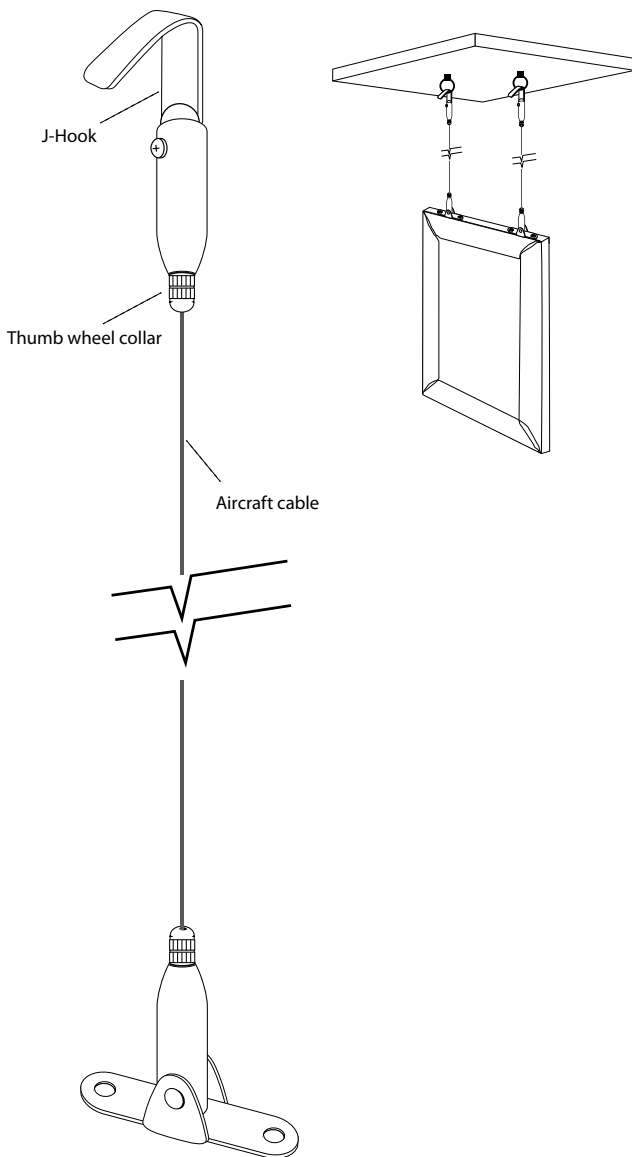

J-Hook Aircraft Cable

Cable length: 39 1/2" (1000mm)
 This cable is used for LED light boxes less than 8 kg.
 (Frame size smaller than 22" x 28")

INSTALLATION INSTRUCTIONS USING J-HOOK AIRCRAFT CABLE

IMPORTANT:

Load capacity is 4 kilograms/8.8 pounds per cable. Ensure that ceiling area can withstand your LED light box total weight before installation.

INSTRUCTIONS:

- 1) Disassemble J-Hook assembly located at end of aircraft cable by unscrewing (counter clockwise) etched "thumb wheel collar" at end of J-Hook style assembly, and then sliding collar down on cable towards connected end of cable at light box area. (aircraft cable should now "slide" freely in the J-Hook assembly)
- 2) Determine desired length of supplied aircraft cables, with measuring tape (for final hanging height), taking into account added length of the J-Hook assembly, and any hardware on the ceiling that the J-Hook will be attached to. Position aircraft cable in J-Hook assembly such that this desired length is achieved.
- 3) Once final position / height is achieved, cut off any extra cable using SHARP wire cutters at area where aircraft cable exits top hole in J-Hook assembly.
- 4) Reposition "thumb wheel collar" onto / over lower threaded end of J-Hook assembly, and rotate collar clockwise ascending upwards onto / over thread. Turn collar until very tight. Aircraft cable should be now locked in place. (cannot slide out of J-Hook assembly) Repeat process with second J-Hook assembly.
- 5) Attach finished J-Hook assemblies onto / into appropriate corresponding hardware previously installed (by you), on / in the desired ceiling area.

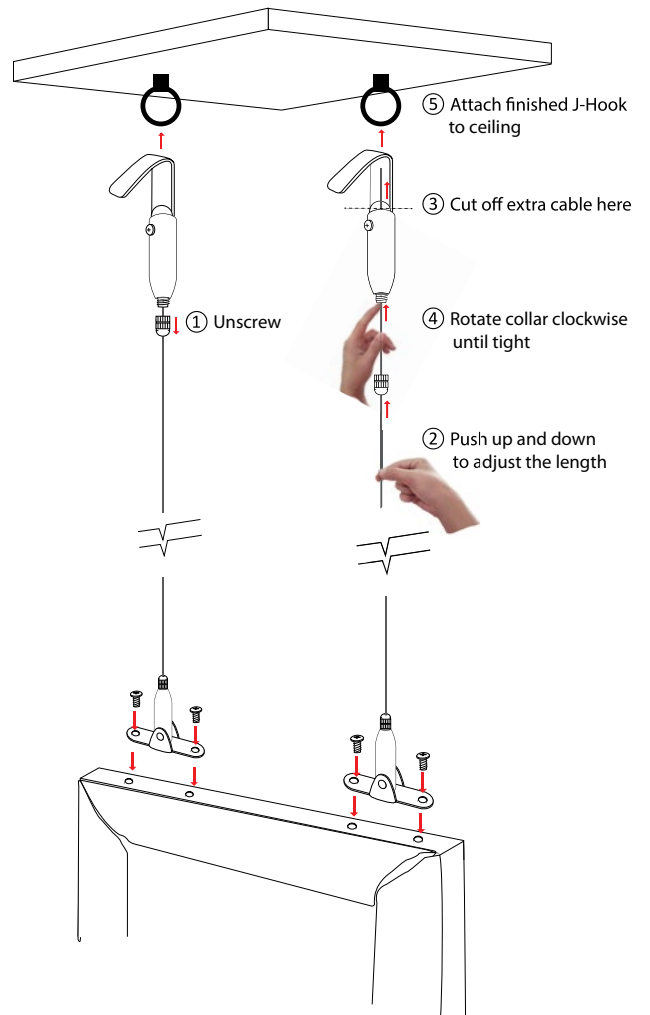

MOUNTING OPTIONS *(All Mounting Hardware Sold Separately)*

2 C-SET

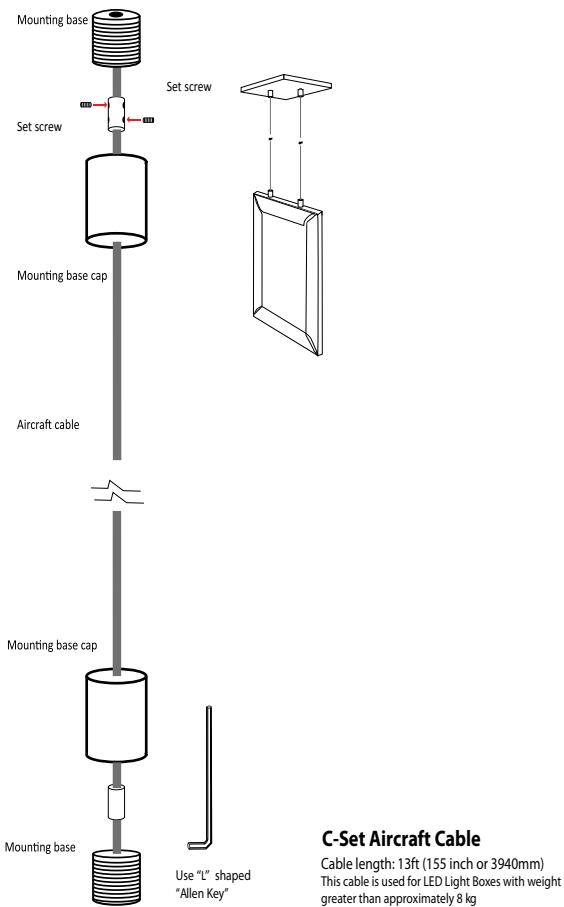

INSTALLATION INSTRUCTIONS USING C-SET AIRCRAFT CABLE

IMPORTANT:

Load capacity is 120kg per cable
Ensure that ceiling area can withstand your LED light box total weight before installation.

Recommended anchors (Not supplied)

- 1) Wood screws if ceiling material is wood
- 2) "Tap cons" or concrete anchors if ceiling material is concrete
- 3) If ceiling is regular drywall / gyp rock, then 3/4 inch plywood "blocking" must be installed behind drywall, for greatest strength. If this is not possible, then you can also use "E Z Ancor Toggle Lock", but drywall must be able to withstand light box total weight on its own. (DLC / Fawoo Canada cannot / will not be responsible for any injuries or damages caused by improperly installed LED light box's. If in doubt, please consult a professional)

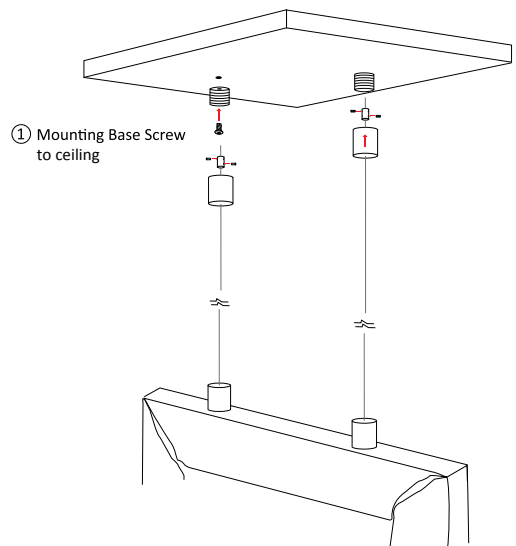

INSTRUCTIONS:

- 1) Attach two (provided) "threaded mounting base"(s), to ceiling, by inserting desired hardware (screws/hardware not provided, see above) through opening in center of threaded base, and then into ceiling material / anchor / reinforced area above. Ensure that the mount distance between these two threaded base's, (measured center to center) is identical to the distance between the two corresponding finished / covered / threaded bases, (pre-mounted by the factory), on the top side of your led light box.
- 2) Determine desired length of supplied aircraft cables, with measuring tape (for final hanging height), and cut to suit using SHARP wire cutters (not supplied).
- 3) Insert cut / ynished cable length through small hole centered in the "at side (bottom) of one of the two (internally threaded) cylindrical shaped threaded base "cap". Attach the "set screw collar", onto end of cable by passing cable through collar opening, and then tightening the two set screws in the sides of collar with supplied " L" shaped Allen key" (a form of screwdriver). Use / insert short end of Allen key into set screw opening to ensure maximum "torque" when tightening. It is mandatory that the two set screws are TIGHT! Repeat this step for the second (matching) wire assembly.
- 4) Attach these two ynished aircraft cable assemblies onto threaded mounting bases on ceiling by rotating cylindrical shaped "cap" (at each end of cable), clockwise, onto the ceiling mounted threaded base. Rotate until tight. Adjust any height differences between the two cables, (or raise or lower the box) by repositioning the set screw collar assemblies on the aircraft cables.

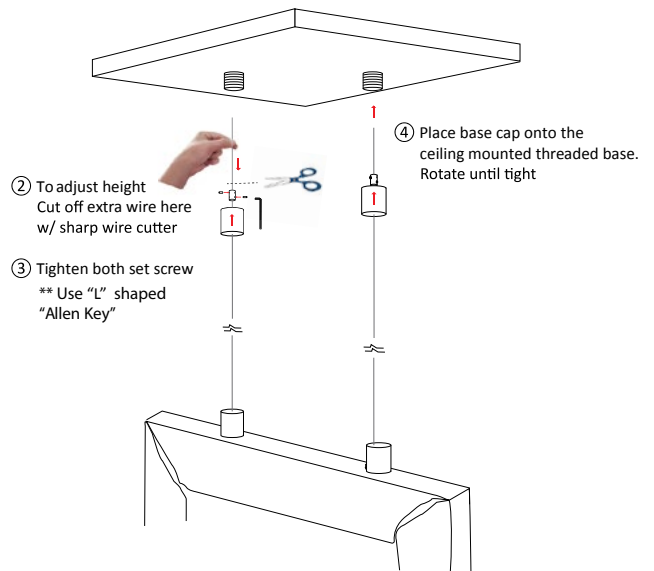



EVO-LITE, LLC

1393 S. Santa Fe Dr. Denver, CO 80223

MAIN PHONE: 303-996-2980

TOLL FREE: 1-888-887-2980

E-MAIL: info@Evo-Lite.com

URL: www.Evo-Lite.com

TERMS & CONDITIONS

Be sure to familiarize yourself with Evo-Lite's Terms & Conditions.
By ordering from Evo-Lite, the purchaser agrees to all Terms & Conditions.

PATENTS

LumiSheet™ PATENTS

USA: 7473022
CANADA: 2,626,448
JAPAN: 4427528
CHINA: ZL 200610085027.0
TAIWAN: 312899
SINGAPORE: 141901
SOUTH AFRICA: 2008/03676
EUROPEAN UNION:
1,780,584
(Germany, UK, France, Italy,
Spain, The Netherlands,
Belgium, Sweden, Austria,
Poland, Denmark, Greece,
Ireland, Finland, Portugal, Czech
Republic, Hungary, Romania,
Slovakia, Bulgaria, Switzerland,
Luxembourg, Slovenia, Turkey,

V-CUTTER FOR AN LCD LIGHT GUIDE PANEL

USA: 6619175
JAPAN: 3500466
TAIWAN: 155175

A LIGHT GUIDE PANEL WITH SALANT LIGHT GUIDING PARTS

USA: US 7,018,087 B2

PIN KIT FOR V-CUTTER

KOREA: 10-0552589, 10-
0557738, 10-0557741,
0540055, 0540053, 10-
0772921, 10-0716543,
10-0565890, 10-0753963,
10-0643604,
10-0736656, 10-0748074,
10-0748073, 10-0762741,
USA: 6792842
JAPAN: 3463060
EU: 1335817
CHINA: ZL 01818623.8
TAIWAN: 163820

Specifications are subject to change without notice.